

FRANZ JÄGER®

Franz Jäger Advanced Digital Lock

FIRE SAFES INSTRUCTION

Instructions for Products

Franz Jäger Brannsafe

Franz Jäger Brandskåp

Franz Jäger Fire Safe

Before installing the safe make sure that the floor bearing capacity is sufficient. The safe must be placed on flat surface. Make sure that the door does not turn by itself in any position. Please note opening space requirement 120 degrees when the safe is equipped with pull-out internal fittings.

Floor anchoring holes and bolts as standard.

HOW TO OPERATE?

How to change batteries

Hold the upper round part and press the opening mark with thumb and lift it up leftward to open. Load batteries, (1.5V AAA Alkaline 4pcs) Then, LED flickers with Bi Bi Bi sound.

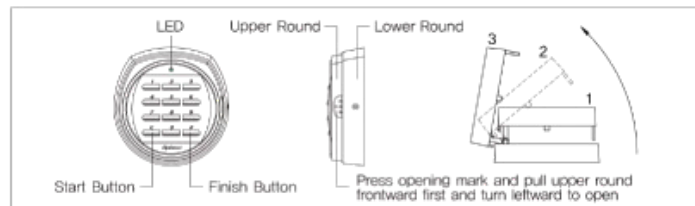

The initial code from the factory is 1 2 3 4.

How to open

Step 1: Push "C" button (LED flickers with Bi sound)

Step 2 : Push the Code buttons (LED flickers with Bi sound)

Step 3: Push "#" button (LED flickers on with melodic tone)

Step 4: Turn knob (or handle) clockwise and open the door while melody rings (3 seconds)

*Note: In case that wrong code is tried, it sounds Bi Bi Bi Bi. If wrong codes are tried over 5 times, the lock gets paralysed and doesn't work.

How to release the lock from paralysis?

Enter the original code twice consecutively as in the opening procedure. No sound but LED flickers when each button pushed, if the procedures are completed exactly, the lock recovers with melodic tone.

EX C1234#C1234# (Led on, Melodic tone)

How to program your personal code

First code

With door open (M>New code>#)

Step 1: Push Memory button “M” on the backside of the door. (LED flickers on with Bi sound)

Step 2: Push New Code buttons (4 digits min and up to 16 digits max, LED flickers on with Bi sound)

Step 3: Push “#” button (Melodic tone)

EX: If a new code is 2100, push buttons as follows: M2100# (melodic tone)

Test your new code!

To confirm if your new code is exactly entered push the new code with the door open.

EX: If your new code is 2100, push buttons as follows to open: C2100#

Test your code twice before closing the door.

If additional code is wanted

Second code

With door open (M>2>#>New 2nd code>#)

Step 1: Push Memory button “M” on the backside of the door. (LED flickers on with Bi sound)

Step 2: Push “2” button (LED flickers on with Bi sound)

Step 3: Push “#” button (LED flickers on with Bi sound)

Step 4: Push 2nd New Code buttons (4 digits min to 16 digits max, LED flickers on with Bi sound)

Step 5: Push “#” button (Melodic tone)

EX: If 2nd code is 4400, push buttons as follows: M2#4400# (melodic tone)

CAUTION: To confirm if the code is correctly entered, try the code with open door before closing the door.

If code is done correct a melody rings for three seconds.

How to erase the 2nd code (Door opened, M>#>2>#)

Step 1: Push Memory button "M" on the backside of the door. (LED flickers on with Bi sound)

Step 2: Push "#" button (Bi sound)

Step 3: Push "2" button (LED flickers with Bi sound)

Step 4: Push "#" button (Bi sound)

When to replace batteries

If door is not opened in spite of exact code entered (LED flickers with sound and melodic tone), it indicates that battery is not strong enough to open the locks. Then, four batteries should be replaced all together with new ones, (1.5V AAA Alkaline 4 pcs)

- The personal code is not erased even if battery is completely flat
- Battery lifetime: 1 year (in case of three door openings a day)

Anchoring of the SAFE

Floor anchoring bolts should be fixed into concrete floor (corresponding anchoring equipment can be used for other floor materials). User of the safe is responsible for the proper anchoring of the safe.

- Install the safe in a place where you can drill 1 or 2 holes
- Check that the drilling spots are safe. Drill holes.
- Use e.g. vacuum cleaner to clean the holes.
- Fix the anchors into the holes.
- Screw the bolts as tight as possible
- Fix the plastic cover plugs back.
- If the standard anchoring material not suitable for your ground (e.g. wooden floor), you can use also an equivalent anchoring material suitable for your ground. Diameter, strength class and dimension shall be the same as the supplied anchoring material.
- If your safe are not to be anchored, the anchoring holes should be filled with a fire resistant mass.